

PGM-FI Control System

Troubleshooting Flowchart — TDC/CRANK/CYL Sensors

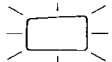

Self-diagnosis LED indicator blinks four times: A problem in the circuit of the CRANK Sensor.



Self-diagnosis LED indicator blinks eight times: A problem in the circuit of the TDC Sensor.

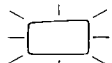

Self-diagnosis LED indicator blinks nine times: A problem in the circuit of the CYL Sensor.

The CRANK sensor determines timing for fuel injection and ignition of each cylinder and also detects engine RPM. The TDC sensor determines ignition timing at start-up (cranking) and when crank angle is abnormal. The CYL sensor detects the position of No.1 cylinder for sequential fuel injection to each cylinder.

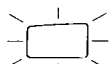
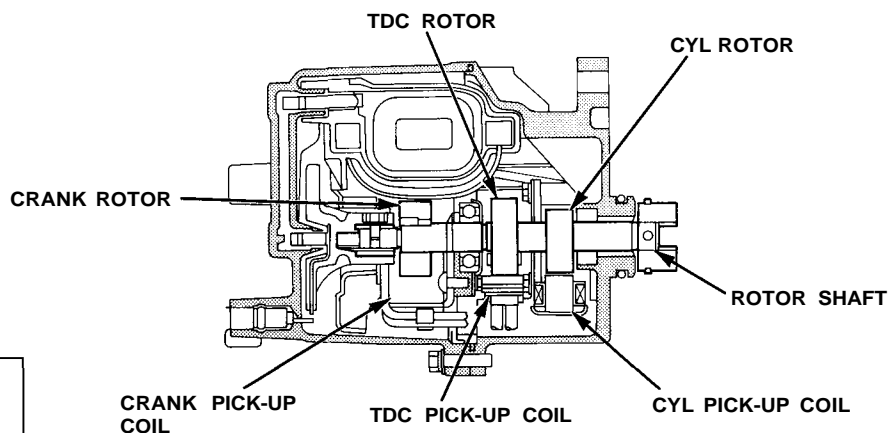

- Check Engine light has been reported on.
- LED indicates CODE 4.

Do the ECU Reset Procedure (page 11-17).

Start engine.

Is Check Engine light on and does LED indicate CODE 4?

NO

YES

Stop engine.

Disconnect the 8P connector from the TDC/CRANK/CYL sensor.

(To page 11-37)

Intermittent failure, system is OK at this time (test drive may be necessary). Check for poor connections or loose wires at the distributor connector and C216 (round connector located at the right shock tower).

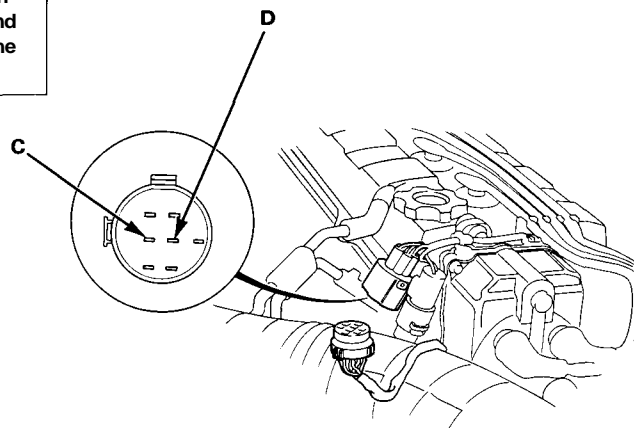

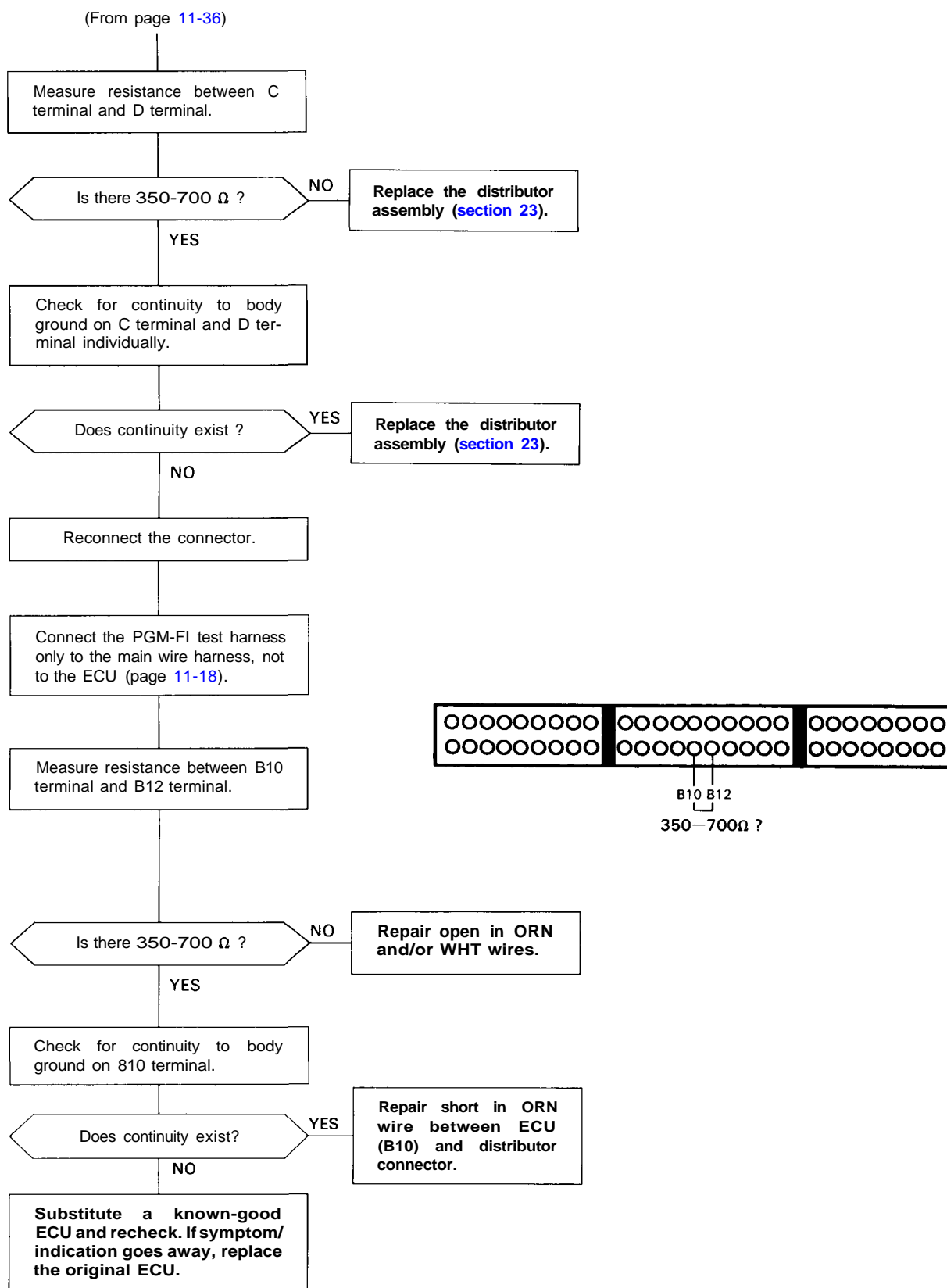

(cont'd)

PGM-FI Control System

Troubleshooting Flowchart — TDC/CRANK/CYL Sensors (cont'd)



- Check Engine light has been reported on.
- LED indicates CODE 8.

Do the ECU Reset Procedure (page 11-17).

Start engine.

Is Check Engine light on and does LED indicate CODE 8?

NO

YES

Stop engine.

Disconnect the 8P connector from the TDC/CRANK/CYL sensor.

Measure resistance between A terminal and B terminal.

Is there 350-700 Ω ?

NO

YES

Check for continuity to body ground on A terminal and B terminal individually.

Does continuity exist ?

YES

NO

Reconnect the connector.

(To page 11-39)

Intermittent failure, system is OK at this time (test drive may be necessary). Check for poor connections or loose wires at distributor connector and C216 (round connector located at the right shock tower).

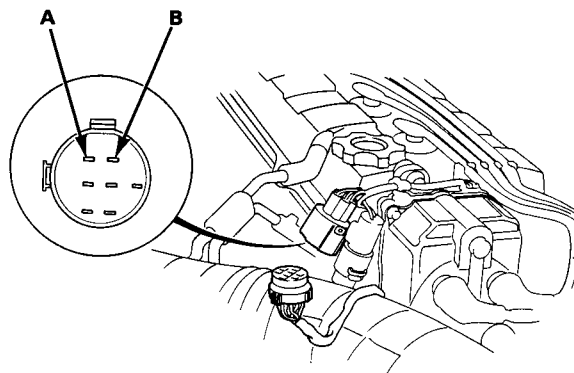

Replace the distributor assembly (section 23).

Replace the distributor assembly (section 23).

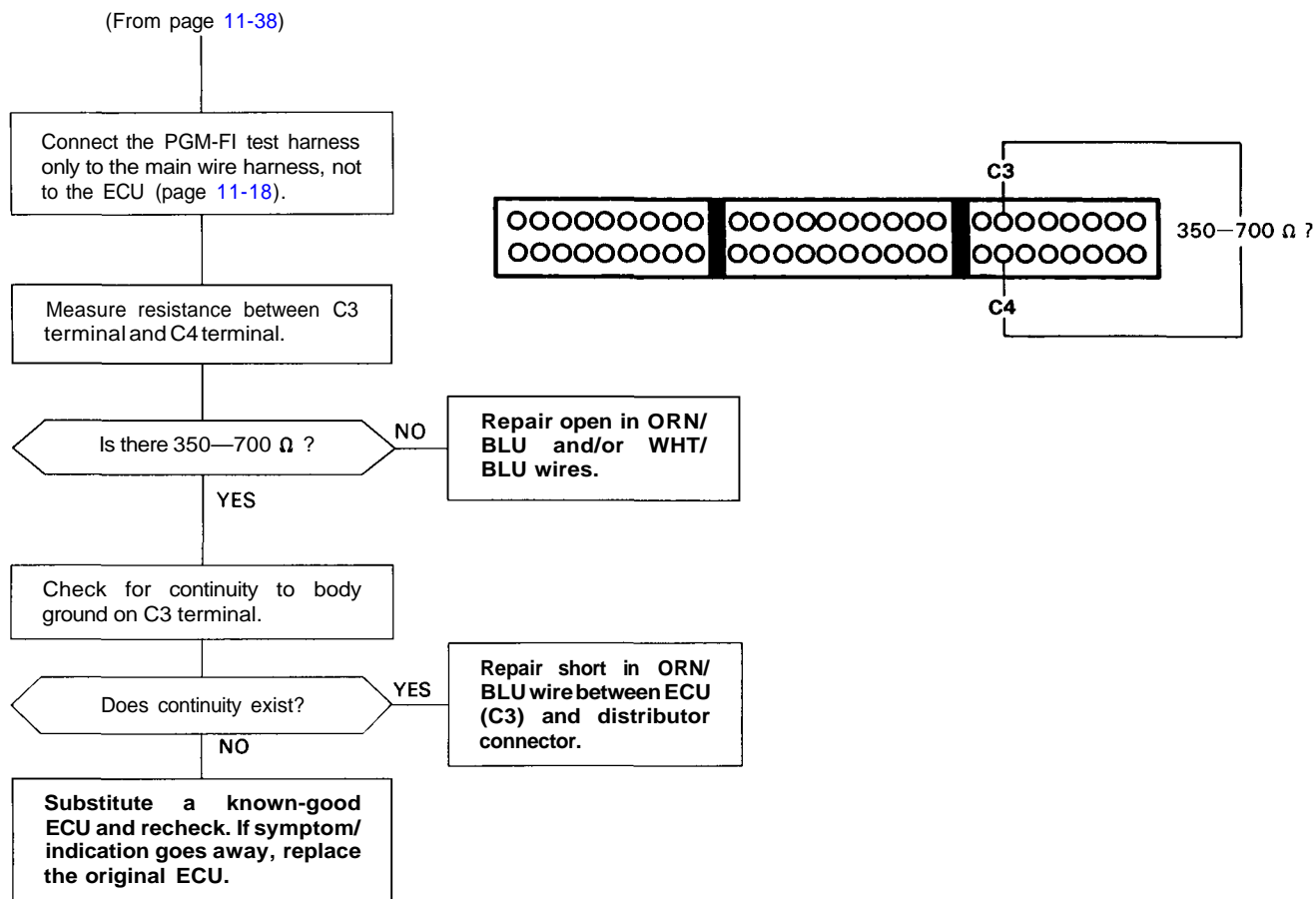

PGM-FI Control System

Troubleshooting Flowchart — TDC/CRANK/CYL Sensors (cont'd)

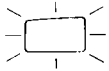

- Check Engine light has been reported on.
- LED indicates CODE 9.

Do the ECU Reset Procedure (page 11-17).

Start engine.

Is Check Engine light on and does LED indicate CODE 9?

NO

Intermittent failure, system is OK at this time (test drive may be necessary).
Check for poor connection or loose wires at the distributor connector and C216 (round connector located at the right shock tower).

YES

Stop engine.

Disconnect the 8P connector from the TDC/CRANK/CYL sensor.

Measure resistance between F terminal and G terminal.

Is there 350-700 Ω ?

NO

Replace the distributor assembly (section 23).

YES

Check for continuity to body ground on F terminal and G terminal individually.

Does continuity exist ?

YES

Replace the distributor assembly (section 23).

NO

Reconnect the connector.

(To page 11-41)

